



# Robinson Road

Rushden, Northamptonshire

oriordanbond  
SALES & LETTINGS



GROUND FLOOR  
466 sq. ft. (43.3 sq. m.) approx.

1ST FLOOR  
397 sq. ft. (36.9 sq. m.) approx.

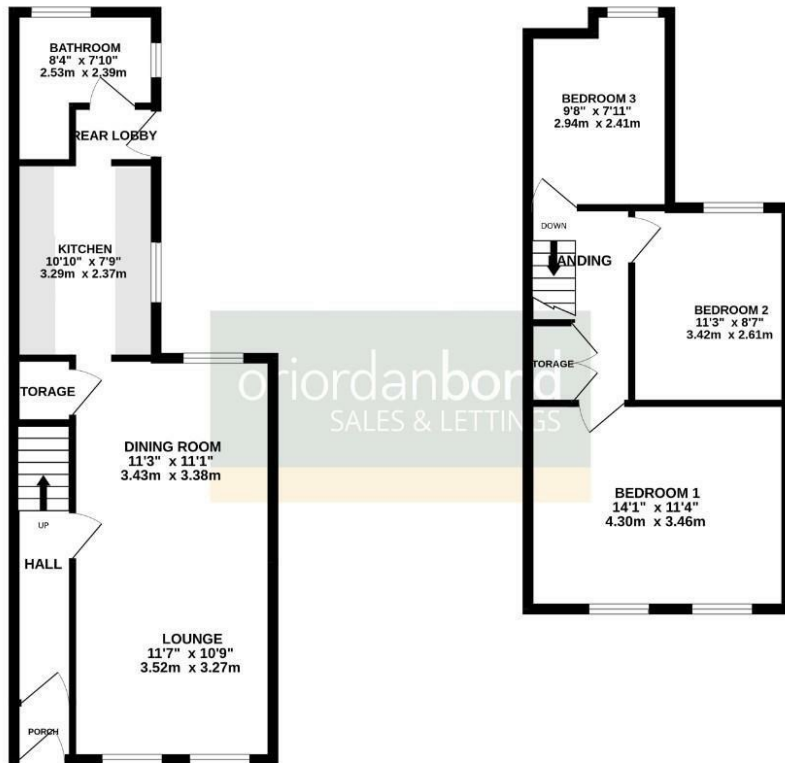

TOTAL FLOOR AREA: 864 sq. ft. (80.2 sq. m.) approx.

Whilst every attempt has been made to ensure the accuracy of the floorplan contained here, measurements of areas, volumes, rooms and any other items are approximate and no responsibility is taken for any error, omission or mis-statement. This plan is for illustrative purposes only and should be used as such by any prospective purchaser. The services, systems and appliances shown have not been tested and no guarantee as to their operability or efficiency can be given.  
Made with Homestyler (2020)

## Robinson Road

Rushden

NN10 0EH

PRICE £215,000

### Additional information

- Council Tax Band: A
- Energy Efficiency Rating: D

### Viewing

Viewing strictly by appointment – details below

### Disclaimer

O'Riordan Bond Estate Agents Limited has not tested apparatus, equipment, fittings or services and so cannot verify they are in working order. The buyer is advised to obtain verification from their solicitor or surveyor.

O'Riordan Bond Rushden Sales

01933 316316

rushden@oriordanbond.co.uk

